



The Garden Retreat of South Bangalore

RERA Registration No. PR/KN/170731/000508



Brigade7Gardens.org





THE GARDENS WELCOME YOU

Brigade 7 Gardens is nature's address in South Bangalore. Experience a truly unique landscape where luxurious towers are surrounded by seven beautiful gardens. Sit back and watch life blossom in the midst of nature and luxury.





7 GARDENS

BRIGADE
7 GARDENS CLUB HOUSE

GARDENS



BRIGADE



7 GARDENS OF HAPPINESS

A garden is a place where we can sit back and take in the little pleasures of life. We may visit a garden to find kinship, or sometimes, a little solitude. We can play like children or just bask in the sunshine. We may wish to enjoy nature's bounty or perhaps even little magic. How wonderful would it be if we had a special garden for each of our pleasures?

All of our seven gardens have been conceptualised with the idea of beautifying every aspect of life, and have been landscaped not on podiums but on rich, fertile soil, just the way nature intended.



The 7 Magical Gardens



The Garden of Solitude

Spending some quality time by ourselves has become imperative in a world where we are always connected. With quiet corners, calming water features, and beautiful stone groupings, the Garden of Solitude is an oasis of serenity and rejuvenation. "In solitude there is healing."



The Garden of Surprise

Nothing is quite as magical as nature. The Garden of Surprise has been crafted to bring out the most wondrous, amazing aspects of nature. Step into a colourful wonderland packed with scaled up as well as minituarised landscaping and awe-inspiring sculptures that add a touch of fantasy to the ambience.



The Garden of Sway

Created to bring out the inner child in all of us, the Garden of Sway is full of fun activities and exercise areas. Equipped with play courts, jogging tracks, and open gardens, it is the perfect place for the young and the young at heart. "It's happy talent to know how to play."



The Garden of Sunshine

The solar garden is the place to experience a brilliant sunshine at the terraces of BGS. With city views and interactive spaces, it is designed to be the right place where the breeze and the sunshine takes over one's experience. Planting in these landscape terraces adds more softness to the visual experience. It should also be a place to learn and enjoy tapping the world's best source of energy.



The Garden of Senses

A wondrous garden that has been created to evoke our sense of sight, smell, sound, touch and above all else, wonder. Whether it's the fragrance of aromatic flowers, the sounds of birds chirping, or even the motion sensor fountains, the garden of senses is a delightful place to spend the afternoon.



The Garden of Source

Who doesn't love fresh produce from their own backyard? With mango, banana, gooseberry and lemon trees, along with vegetable patches, the Garden of Source is a dream come true for organic food lovers. "To plant a garden is to believe in tomorrow."



The Social Garden

A sprawling garden is specially designed so that we can make the most of our time with friends and family. Apart from the beautiful park benches and walking paths, the Social Garden also boasts for its event space and a clubhouse. So let's find the every excuse to spend time with those we love. "Societies are built on the soft strong bonds of sharing."

LIVE IN A FAST-GROWING NEIGHBOURHOOD

KEY DISTANCES



01	02
National Public School 0.6 km	KSIT Metro Station 3 km
03	04
Metro Cash & Carry 4 km	Delhi Public School 5 km
05	06
Nice Corridor Road 7 km	BGS Hospital 5 km
07	08
Brigade School J P Nagar 8 km	Bannerghatta Road 10 km
09	10
Apollo Hospital 10 km	MG Road 15 km

A WORLD OF MODERN AGE CONNECTIVITY

Enjoy the added advantage of Bangalore's Namma Metro Network



NH 209 Proposed 4-lane highway

Functional KSIT College Metro Station
5 minutes' drive from Brigade 7 Gardens

Rejuvenation is just a walk away

<p>Tarhalli Forest A 102-acre forest in which 100 acres are suitable for walking, mountain climbing and water activities.</p>	<p>Art of Living Bangalore's first health and self-empowerment center.</p>
<p>Pyramid Valley A meditation center amidst the spiritual heights of the world's longest.</p>	<p>ISKCON Theme Park A magnificent cultural complex dedicated to Lord Krishna.</p>

Education & recreation is just a hop, skip & jump away

<p>COLLEGES Indian Business Academy, Indian Institute of Journalism, KSIT, Dayananda Sagar, APS, Jain Institution</p>	<p>SCHOOLS National Public School, Valley School, Sri Karmaveer Children's Home, Delhi Public School, Yashwanthi School, BGS International School, Jain School.</p>
<p>HEALTHCARE Fortis, Apollo & BGS Hospitals</p>	<p>RECREATION AND SHOPPING Ghantara, Wondra, Meenakshi Mall, Metro Cash and Carry</p>

Quick commute to major parts of the city

Yelachenahalli Metro Station	Global Village Tech Park
Banewarhatta Road	Horahalli Industrial Area
Electronic City	Bidadi



Brigade 7 Gardens is nature's address in South Bangalore



CO-DESIGNED BY NATURE

Seven stately towers, rising above the lush foliage and rolling hillocks of Banashankari. The inspired architecture blends seamlessly with the natural beauty of landscape, inviting you to this haven of tranquility. No matter where you look, you will always have a view of one of the seven gardens that surround your home. Intricate trellises woven with exotic vines have been incorporated in the architecture of each home, ensuring plenty of greenery on every floor. And, the Thurahalli forest keeps every home blessed with bounty of fresh air.





ENJOY THE SIMPLE JOYS OF LIFE

From farming your home produce to working out in an open-air gymnasium, living in Brigade 7 Gardens is all about relishing the simple joys of life, in luxury.



Multi-purpose hall



Swimming pool



Billiards



Convenience store



Table tennis



Badminton court



Aerobics



Gymnasium

Swimming Pool



Towers surrounded by 7 beautiful gardens



Enjoy fresh produce from the Garden of Source



Watch the kids play at the Garden of Sway



The delightful Garden of Senses



Rejuvenate at the Garden of Solitude





MASTER PLAN OF BRIGADE 7 GARDENS - ALL BLOCKS



LEGEND

- 1. ENTRY & EXIT
- 2. CLUB ENTRY
- 3. BLOCK ENTRY
- 4. DRIVEWAY
- 5. BRIDGE
- 6. PARKING
- 7. BASEMENT RAMP
- 8. BASKET BALL COURT
- 9. TENNIS COURT
- 10. BADMINTON COURT
- 11. SOURCE GARDEN
- 12. SEATING AREA
- 13. SURPRISE GARDEN
- 14. SENSORY GARDEN
- 15. SWAY GARDEN
- 16. SOLITUDE GARDEN
- 17. SLURKEN SEATING
- 18. NVA BUFFER AREA PLANTING
- 19. SOCIAL GARDEN
- 20. TRANSFORMER YARD
- 21. OWC
- 22. GAS BANK
- 23. RMU

■■■■■■■■■■ PARK & OPEN SPACES

■■■■■■■■■■ CIVIC AMENITIES

600 ACRE
THURAHALLI FOREST RESERVE



Not to scale



NUMBERING PLAN OF BRIGADE 7 GARDENS - ALL BLOCKS

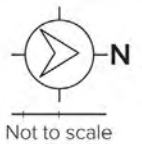
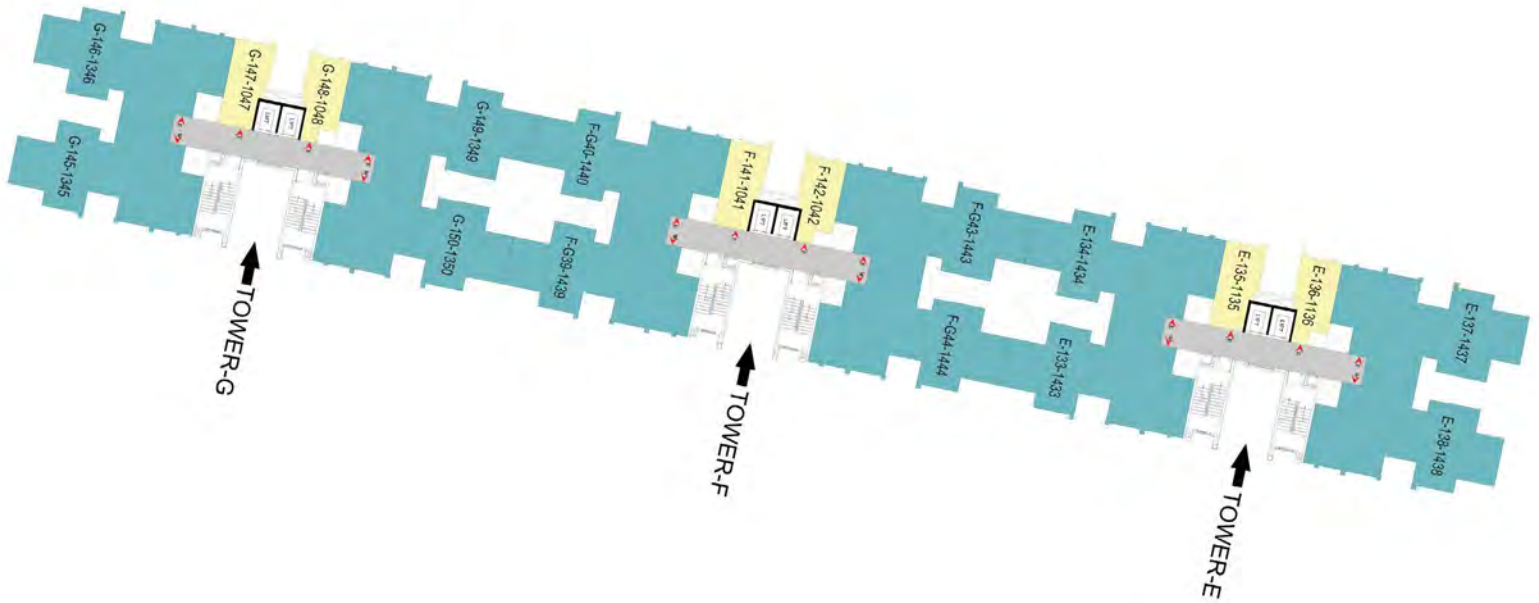

UNIT TYPE	
	TYPE-01 2 BEDROOMS + 2 TOILETS
	TYPE-02 3 BEDROOMS + 2 TOILETS
	TYPE-03 3 BEDROOMS + 2 TOILETS
	TYPE-04 2 BEDROOMS + 2 TOILETS
	TYPE-05 3 BEDROOMS + 2 TOILETS
	TYPE-06 2 BEDROOMS + 2 TOILETS
	TYPE-07 3 BEDROOMS + 2 TOILETS
	STUDIO 1 BEDROOM + 1 TOILET



NUMBERING PLAN OF TOWERS B, C & D (G+14 Floors)

TOWER B

TOWER C

TOWER D

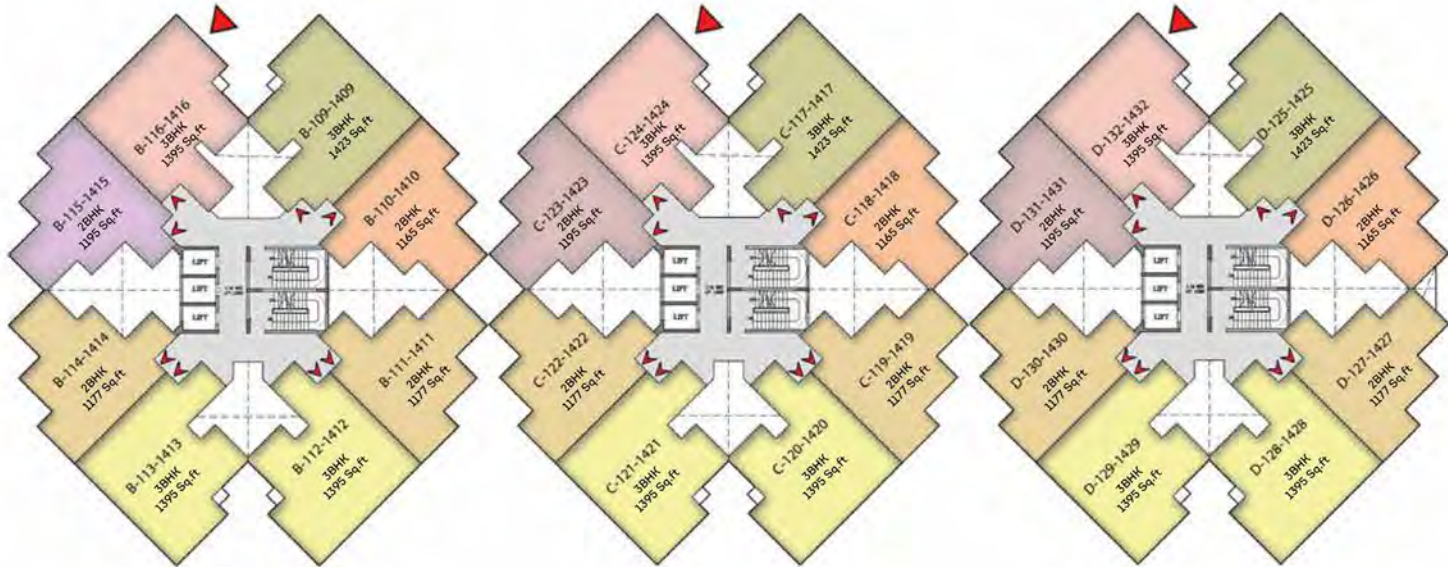

2BHK: 1165 Sq.ft (10, 18, 26)

3BHK: 1395 Sq.ft (13, 16, 21, 23, 29, 31)

2BHK: 1177 Sq.ft (14, 22, 30, 11, 19, 27)

3BHK: 1423 Sq.ft (09, 12, 17, 20, 25, 28)

2BHK: 1195 Sq.ft (15, 23, 31)



NUMBERING PLAN OF TOWERS E & F (G + 14 Floors) and G (G + 13 Floors)

TOWER E (G+14 Floors)



TOWER F (G+14 Floors)



TOWER G (G+13 Floors)



E Block: 1603 Sq.ft (37, 38, 33, 34)	Studio Apt: 371 Sq.ft (35, 36)
F Block: 1603 Sq.ft (39, 40, 43, 44)	Studio Apt: 371 Sq.ft (41, 42)
G Block: 1603 Sq.ft (45, 46, 49, 50)	Studio Apt: 371 Sq.ft (47, 48)

TYPICAL STUDIO UNIT

SUPER BUILT-UP AREA

371 sq.ft. / 34.46 sq.m
(Shown below)

CARPET AREA

244.45 sq.ft. / 22.70 sq.m
(Shown below)

SERIES

E Block: 35 & 36 | G Block: 47 & 48
F Block: 41 & 42



BLOCK PLAN

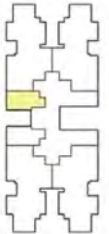

E, F, G



Not to scale

The information depicted herein viz., master plans, floor plans, furniture layout, fittings, illustrations, specifications, designs, dimensions, rendered views, colours, amenities and facilities etc., are subject to change without notifications as may be required by the relevant authorities or the developer's architect, and cannot form part of an offer or contract. Whilst every care is taken in providing this information, the Developer cannot be held liable for variations. All illustrations and pictures are artist's impression only. The information are subject to variations, additions, deletions, substitutions and modifications as may be recommended by the company's architect and/or the relevant approving authorities. The Developer is wholly exempt from any liability on account of any claim in this regard. (1 square metre = 10.764 square feet). E & OE.

Carpet area is defined as the net usable floor area of an apartment, excluding the area covered by the external walls, areas under services shafts, exclusive balcony or verandah area and exclusive open terrace area, but includes the area covered by the internal partition walls of the apartment.

TYPICAL UNIT PLAN

2-Bedroom 2-Toilet Unit

SUPER BUILT-UP AREA

1165 sq.ft. / 108.22sq.m
(Shown below)

CARPET AREA

758.97 sq.ft. / 70.51 sq.m
(Shown below)

SERIES

A Block: 1 & 8
B Block: 10

C Block: 18
D Block: 26



BLOCK PLAN



A

B, C, D



Not to scale

The information depicted herein viz., master plans, floor plans, furniture layout, fittings, illustrations, specifications, designs, dimensions, rendered views, colours, amenities and facilities etc., are subject to change without notifications as may be required by the relevant authorities or the developer's architect, and cannot form part of an offer or contract. Whilst every care is taken in providing this information, the Developer cannot be held liable for variations. All illustrations and pictures are artist's impression only. The information are subject to variations, additions, deletions, substitutions and modifications as may be recommended by the company's architect and/or the relevant approving authorities. The Developer is wholly exempt from any liability on account of any claim in this regard. (1 square metre = 10.764 square feet). E & OE.

Carpet area is defined as the net usable floor area of an apartment, excluding the area covered by the external walls, areas under services shafts, exclusive balcony or verandah area and exclusive open terrace area, but includes the area covered by the internal partition walls of the apartment.

TYPICAL UNIT PLAN

2-Bedroom 2-Toilet Unit

SUPER BUILT-UP AREA

1165 sq.ft. / 108.22sq.m
(Shown below)

CARPET AREA

758.97 sq.ft. / 70.51 sq.m
(Shown below)

SERIES

A Block: 1 & 8
B Block: 10

C Block: 18
D Block: 26



BLOCK PLAN



A

B, C, D



Not to scale

The information depicted herein viz., master plans, floor plans, furniture layout, fittings, illustrations, specifications, designs, dimensions, rendered views, colours, amenities and facilities etc., are subject to change without notifications as may be required by the relevant authorities or the developer's architect, and cannot form part of an offer or contract. Whilst every care is taken in providing this information, the Developer cannot be held liable for variations. All illustrations and pictures are artist's impression only. The information are subject to variations, additions, deletions, substitutions and modifications as may be recommended by the company's architect and/or the relevant approving authorities. The Developer is wholly exempt from any liability on account of any claim in this regard. (1 square metre = 10.764 square feet). E & OE.

Carpet area is defined as the net usable floor area of an apartment, excluding the area covered by the external walls, areas under services shafts, exclusive balcony or verandah area and exclusive open terrace area, but includes the area covered by the internal partition walls of the apartment.

TYPICAL UNIT PLAN

2-Bedroom 2-Toilet Unit

SUPER BUILT-UP AREA

1195 sq.ft. / 111.05 sq.m
(Shown below)

CARPET AREA

775.33 sq.ft. / 72.03 sq.m
(Shown below)

SERIES

B Block: 15
C Block: 23

D Block: 31



BLOCK PLAN

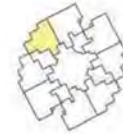

B, C, D



Not to scale

The information depicted herein viz. master plans, floor plans, furniture layout, fittings, illustrations, specifications, designs, dimensions, rendered views, colours, amenities and facilities etc., are subject to change without notifications as may be required by the relevant authorities or the developer's architect, and cannot form part of an offer or contract. Whilst every care is taken in providing this information, the Developer cannot be held liable for variations. All illustrations and pictures are artist's impression only. The information are subject to variations, additions, deletions, substitutions and modifications as may be recommended by the company's architect and/or the relevant approving authorities. The Developer is wholly exempt from any liability on account of any claim in this regard. (1 square metre = 10.764 square feet). E & OE.

Carpet area is defined as the net usable floor area of an apartment, excluding the area covered by the external walls, areas under services shafts, exclusive balcony or verandah area and exclusive open terrace area, but includes the area covered by the internal partition walls of the apartment.

TYPICAL UNIT PLAN

3-Bedroom 2-Toilet Unit

SUPER BUILT-UP AREA

1395 sq.ft. / 129.59 sq.m
(Shown below)

CARPET AREA

922 sq.ft. / 85.63 sq.m
(Shown below)

SERIES

A Block: 3 & 6
B Block: 12, 13 & 16

C Block: 20, 21 & 24
D Block: 28, 29 & 32



BLOCK PLAN

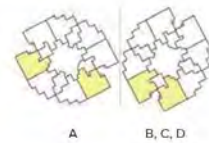

A

B, C, D



Not to scale

The information depicted herein viz. master plans, floor plans, furniture layout, fittings, illustrations, specifications, designs, dimensions, rendered views, colours, amenities and facilities etc., are subject to change without notifications as may be required by the relevant authorities or the developer's architect, and cannot form part of an offer or contract. Whilst every care is taken in providing this information, the Developer cannot be held liable for variations. All illustrations and pictures are artist's impression only. The information are subject to variations, additions, deletions, substitutions and modifications as may be recommended by the company's architect and/or the relevant approving authorities. The Developer is wholly exempt from any liability on account of any claim in this regard. (1 square metre = 10.764 square feet). E & OE.

Carpet area is defined as the net usable floor area of an apartment, excluding the area covered by the external walls, areas under services shafts, exclusive balcony or verandah area and exclusive open terrace area, but includes the area covered by the internal partition walls of the apartment.

TYPICAL UNIT PLAN

3-Bedroom 2-Toilet Unit

SUPER BUILT-UP AREA

1423 sq.ft. / 132.23 sq.m
(Shown below)

CARPET AREA

942 sq.ft. / 87.56 sq.m
(Shown below)

SERIES

A Block: 7
B Block: 9

C Block: 17
D Block: 25



BLOCK PLAN

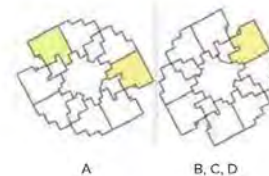

Not to scale

The information depicted herein viz., master plans, floor plans, furniture layout, fittings, illustrations, specifications, designs, dimensions, rendered views, colours, amenities and facilities etc., are subject to change without notifications as may be required by the relevant authorities or the developer's architect, and cannot form part of an offer or contract. Whilst every care is taken in providing this information, the Developer cannot be held liable for variations. All illustrations and pictures are artist's impression only. The information are subject to variations, additions, deletions, substitutions and modifications as may be recommended by the company's architect and/or the relevant approving authorities. The Developer is wholly exempt from any liability on account of any claim in this regard. (1 square metre = 10.764 square feet). E & OE.

Carpet area is defined as the net usable floor area of an apartment, excluding the area covered by the external walls, areas under services shafts, exclusive balcony or verandah area and exclusive open terrace area, but includes the area covered by the internal partition walls of the apartment.

TYPICAL UNIT PLAN

3-Bedroom 3-Toilet Unit

SUPER BUILT-UP AREA

1603 sq.ft. / 148.94 sq.m
(Shown below)

CARPET AREA

1059.29 sq.ft. / 98.41 sq.m
(Shown below)

SERIES

E Block: 33, 34, 37 & 38
F Block: 39, 40, 43 & 44
G Block: 45, 46, 49 & 50



BLOCK PLAN



E, F, G



Not to scale

The information depicted herein viz., master plans, floor plans, furniture layout, fittings, illustrations, specifications, designs, dimensions, rendered views, colours, amenities and facilities etc., are subject to change without notification as may be required by the relevant authorities or the developer's architect, and cannot form part of an offer or contract. Whilst every care is taken in providing this information, the Developer cannot be held liable for variations. All illustrations and pictures are artist's impression only. The information are subject to variations, additions, deletions, substitutions and modifications as may be recommended by the company's architect and/or the relevant approving authorities. The Developer is wholly exempt from any liability on account of any claim in this regard. (1 square metre = 10.764 square feet). E & OE.

Carpet area is defined as the net usable floor area of an apartment, excluding the area covered by the external walls, areas under services shafts, exclusive balcony or verandah area and exclusive open terrace area, but includes the area covered by the internal partition walls of the apartment.



SPECIFICATIONS

FOUNDATION

Isolated/Combined footing

SUPER STRUCTURE

RCC framed structure

BLOCK WORK

Block work

FLOORING-COMMON AREAS

Waiting lounge / reception / GF Lobby /

Lift lobby: Granite/Vitrified tiles

Staircases: Step tiles/Stone-Eurocon

Other lift Lobby and corridor (Upper): Vitrified tiles - 600 x 600mm

Service lift lobby: Vitrified tiles - 600 x 600 mm

MEP rooms: IPS floor with smooth finish

Terrace: Clay tiles with water proofing

Basement: VDF/IPS with smooth finish

FLOORING-RECREATION HOUSE (CLUB)

Lobby: Vitrified flooring

Gym: Vinyl flooring

Multipurpose hall: Vitrified flooring

FLOORING-UNITS

Living / Dining / Family / Foyer: Vitrified tiles - 600 x 600 mm

Master Bedrooms: Laminated wood en flooring /Vitrified flooring

Balcony/Deck: Antiskid ceramic tiles - 300 x 300 mm

Master Bedroom toilet: Ceramic tiles

Other toilets and powder room: Ceramic tiles

Kitchen: Vitrified tiles - 600 x 600 mm

Utility: Vitrified tiles - 600 x 600 mm (same as kitchen tiles)

Studio unit: Vitrified tiles - 600 x 600 mm (same as kitchen tiles)

WALL DADO

Master Bedroom toilet: Glazed tile cladding upto false ceiling

Other toilets: Glazed tile cladding upto false ceiling.

SPECIFICATIONS

KITCHEN

Counter: Provision for modular kitchen

Plumbing/Electrical: Plumbing: Provision for water purifier/hot & cold water mixer in sink and washing machine

Electrical: 16 amps - 3 numbers (washing machine, microwave oven, instant geyser), 6 amps - 5 numbers (fridge/hob/chimney/aquaguard/mixer/exhaust)

TOILETS

CP Fittings: AU CP fittings of ESS ESS/Jaguar or equivalent

Sanitary fixtures: Wall mounted white EWC with exposed flush tank (Parryware/Hindware/equivalent) with low level ceramic flushing tank of standar make including health faucet

Accessories: Soap tray, toilet paper holder, basin mixer, robe hook, towel rod, health faucet

Master bedroom toilet: Shower partition at extra cost as per client request

Shower: Wall Mixer for shower (Jaquar/ Ess Ess or equivalent)

Wash basin-counter top: Master Bathroom- Granite counter other bathrooms- readymade counter and wash basin

False Ceiling: Sintex/calcium silicate 2'X2' Grid

DOORS

Main entry door - to unit: Hardwood door frames with designer panel shutters polished on both sides. Night latch for main door with Magic eye

Bedroom doors: Flush door with both side Synthetic Enamel painted. Mortice lock for bedrooms only

Toilet door: Hard wood frame both side commercial flush shutter resin coated and thumb turn for the toilets

Utility: Not provided as utility is part of kitchen. Only window provided

Balcony door: UPVC/Aluminium glazed sliding door

Shaft door: MS door frame with steel shutter/standard

RAILING

Balcony railing: MS railing-vertical only and spacing to be not more than 150 mm

Staircase Railing (Common areas): MS railing-vertical only and spacing to be not more than 150 mm

Living Room



Dining



Kitchen



WAKE UP TO A GARDEN BREEZE EVERY MORNING.

Wake up to the view of a unique garden that lends to the essence of living in the Garden City. Comprising of 2 & 3 bedroom apartments, designed to maximise ventilation, the airy interiors allow you to enjoy the cool breeze of the gardens, even when you're indoors.

AWARDS AND ACCOLADES



Brigade was recognized as one of India's Top Builders at the Construction World Architects & Builders Award 2018.

Brigade was recognized as one of Bengaluru's Hot 50 Brands at the Brand Summit & Hot Brands 2018 by Paul Writer.

Brigade Orchards won the 'Integrated Township of the Year' award at the Realty+ Excellence Awards South 2018.

Brigade has been recognized for being amongst India's Best Workplaces in Real Estate, at the Great Place To Work For 2018 Awards.

Brigade won the 'Real Estate Luminary Award' for Exemplary contribution to Real Estate at the Times Business Awards 2018

Brigade Orchards won the 'Smart Township Project of The Year' Award at the 6th Annual Siliconindia Bengaluru Real Estate Awards' 2018.

Brigade Exotica won the Best Residential Project at the CIA World Construction & Infra Awards 2018

Brigade Palmgrove won the Premium Villa Project of the Year at the NDTV Property Awards 2018

Brigade Palmgrove won in the 'Villas & Row Houses' category at the CREDAI Karnataka's CARE Awards 2017.

THE WORLD OF BRIGADE



BRIGADE

Building Positive Experiences

DEVELOPER OF BANGALORE'S TALLEST
COMMERCIAL BUILDING
1986 - BRIGADE TOWERS
2010 - WORLD TRADE CENTER

OUR CUSTOMERS ARE OUR BEST AMBASSADORS

INDIA'S FIRST ACCELERATOR FOCUSED
ON REAL ESTATE, RETAIL AND HOSPITALITY.
LEVERAGING TECHNOLOGY AND
INNOVATION FOR OPERATIONAL EFFICIENCY

OUR SCHOOLS PROVIDE
HOLISTIC, INSPIRING AND
EMPOWERING EDUCATION

Brigade Foundation
EDUCATION | HEALTH | COMMUNITY DEVELOPMENT



OVER
20,000
HAPPY FAMILIES

BRIGADE
REAP
REAL ESTATE ACCELERATOR PROGRAM

**Indian
music**
EXPERIENCE

INDIA'S FIRST
EXPERIENTIAL
MUSIC MUSEUM

CREATORS OF
BRIGADE GATEWAY
BANGALORE'S
1st INTEGRATED ENCLAVE

PIONEERS
OF
INTEGRATED ENCLAVES

**WORLD TRADE
CENTER**



HOSPITALITY
PRESENCE ACROSS
SOUTH INDIA

PARTNERSHIP WITH
RENOWNED GLOBAL
HOSPITALITY BRANDS

LICENSE OWNER OF THE WORLD TRADE CENTER
ACROSS SOUTH INDIA
BANGALORE, CHENNAI, KOCHI,
HYDERABAD & TRIVANDRUM

ONE OF THE BEST REAL ESTATE
COMPANIES TO WORK IN INDIA
BY GREAT PLACE TO WORK
INSTITUTE AND ECONOMIC TIMES

MULTIPLE DOMAINS. SINGLE-MINDED COMMITMENT.

Brigade is one of India's leading developers with over three decades of experience in building positive experiences and also transforming the skyline of cities in South India namely Bangalore, Mysore, Mangalore, Hyderabad, Chennai, Kochi with its developments across Residential, Offices, Retail, Hospitality & Education sectors.

Brigade's residential portfolio includes penthouses, villas, premium residences, luxury apartments, value homes, independent living for seniors and award winning fully integrated lifestyle enclaves and townships. Brigade is among the few developers who also enjoy a reputation of developing Grade A commercial properties. The World Trade Center- Bangalore & Kochi, Software and IT parks, SEZs and stand-alone offices have top international clients operating from them. Brigade's retail projects include Orion Mall at Brigade Gateway, Orion East in Banaswadi and the upcoming Orion OMR. Brigade's hospitality offerings include star hotels across South India, recreational clubs and convention centres, Celebrations Catering and Events and The Baking Company, a unique patisserie focusing on freshly baked healthy products in Bangalore. Brigade has completed over 250 buildings amounting to 40 million sq.ft in residential, offices, retail and hospitality sectors across 7 cities.

The Group has been socially responsible and has vastly contributed to society by redeveloping the SangolliRayanna Park and the Shri NadapraphuKemppegowda Playground in Malleswaram, Bangalore, constructing a Skywalk across Dr.Rajkumar Road and rejuvenation of Sitharampalaya lake in Whitefield. The latest initiative-The Indian Music Experience (IME) - a monumental and philanthropic initiative of Brigade Group is conceived to give back to the society and to sensitise the present generation to the rich culture of Indian music. This responsible attitude and innovative mind-set combined with uncompromising quality of the projects over the years has created a reputed brand.

The Group has also been consistently ranked among the 100 Best Places to Work in India for 8 years in a row. The awards and recognition received by the Group across various categories serve as a testimony to Brigade as a proven brand, well established and trustworthy coupled with excellent customer service and impeccable build quality.

Apartments, Villas, Integrated Enclaves



Offices, School, Retail Spaces



Clubs, Hotels, Convention Centres





BRIGADE

Building Positive Experiences

To **UPGRADE TO BRIGADE**, call us at **1800 102 9977** | email: salesenquiry@brigadegroup.com

Marketing Office: Brigade 7 Gardens, Patalamma Temple Road, Near Bharath Housing Society, Dr. Vishnuvardhan Road, Uttarahalli, Bengaluru, Karnataka-560061.

Also, visit us at

Experience Centre: Ground Level, World Trade Center, Brigade Gateway Campus, Dr. Rajkumar Road, Malleswaram-Rajajinagar, Bangalore.

Dubai Office: Brigade Enterprises Limited, 708, Atrium Centre, Bank Street, Bur Dubai, Dubai. Tel: +971 4 3555504 email: dubaisales@brigadegroup.com
Offices also in Chennai, Hyderabad, Mangalore and Mysore

RERA Registration No. PRM/KA/RERA/1251/310/PR/171021/000508

7G-NOV-2018-500